

1. MECHANICAL OUTLINE

COLOR : Green + Red

Unspecified Tolerances is ± 0.3 

2. CIRCUIT DIAGRAM (LED 2x5=10 dies)

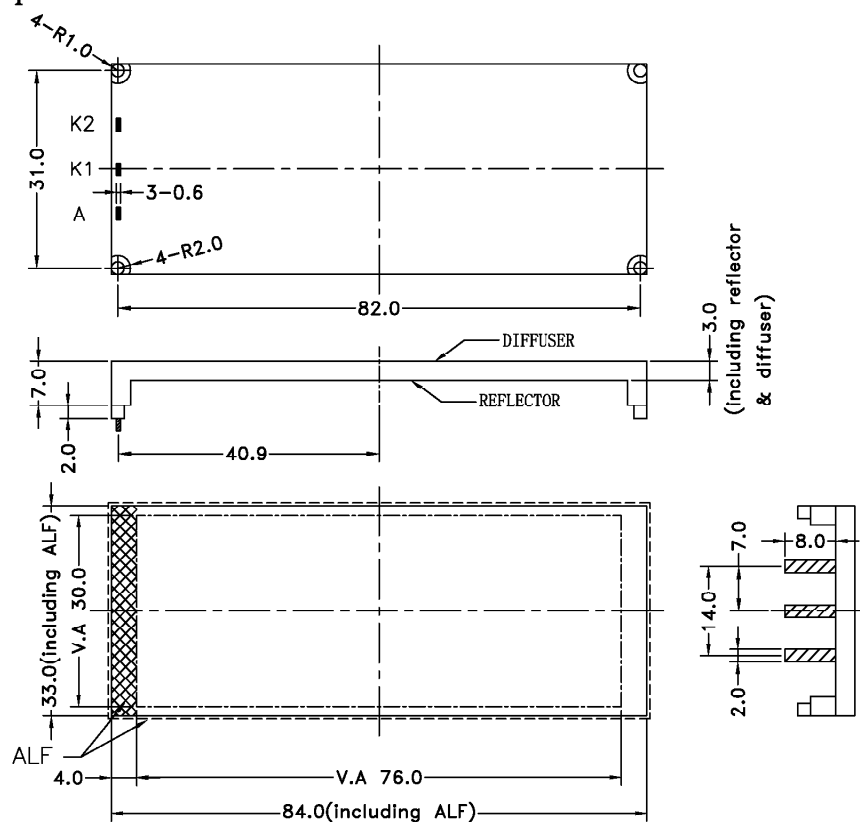
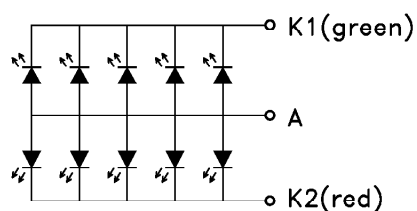

3. STORAGE & SOLDERING CONDITIONS:

- Store with care. Storing the units in bad condition will cause the reflector sheet and decrease its adhesive power. Storage The products under the condition: temperature ($25^{\circ}\text{C} \pm 10^{\circ}\text{C}$) and humidity ($65\% \text{CRH} \pm 20\% \text{CRH}$) our recommendation.
- The Soldering Temperature is $260 \pm 5^{\circ}\text{C}$ and Soldering Time should be less than 3 sec, and soldering iron power should be less than 30W.
- The soldering point should be farther than 1.6mm (1/10") from body .

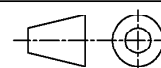

4. ABSOLUTE MAXIMUM RATINGS

REV. B

Unless specified, The Ambient temperature $T_a=25^{\circ}\text{C}$

Item	Symbol	Conditions	Rating		Unit
			(R)	(G)	
* Absolute maximum forward current	Ifm		125	125	mA
* Peak forward current	Ifp	1 msec Plus 10% Duty Cycle	300	300	mA
Reverse Voltage	Vr		5	5	V
* Power dissipation	Pd		250	400	mW
Operating Temperature Range	Topr		$-30\sim+70^{\circ}\text{C}$		$^{\circ}\text{C}$
Storage Temperature Range	Tstg		$-40\sim+80^{\circ}\text{C}$		$^{\circ}\text{C}$

*

For operation above 25°C , The Ifm Ifp & Pd must be derated, the Current derating is $-1.8\times 2\text{ mA}/^{\circ}\text{C}$ for DC drive and $-4.3\times 2\text{ mA}/^{\circ}\text{C}$ for Pulse drive, the Power dissipation is $-3.75\times 2\text{ mW}/^{\circ}\text{C}$. The product working current must not more than the 60 % of the Ifm or Ifp according to the working temperature.

5. ELECTRICAL-OPTICAL CHARACTERISTICS

Unless specified, The Ambient temperature $T_a=25^{\circ}\text{C}$

Item	Symbol	(Red)			(Green)			Unit	Condition
		min.	typ.	max.	min.	typ.	max.		
Forward Voltage	Vf	1.9	2.05	2.2	3	3.3	3.6	V	If=80X2mA
Reverse Current	Ir			100			100	μA	Vr= 5 V
Peak wave length	λ_p		630			525		nm	If=80X2mA
Spectral Line Half width	$\Delta\lambda$		20			30		nm	If=80X2mA
* Luminance	Lv							cd/m^2	If=80X2mA

*

The luminance is the average value of 6 points, and The $L_{v\text{max.}}/L_{v\text{min.}}$ is less than 1.5 Typical (max 1.7). The measurement instrument is BM-7 luminance Colorimeter. The aperture is $\phi 5\text{ mm}$.

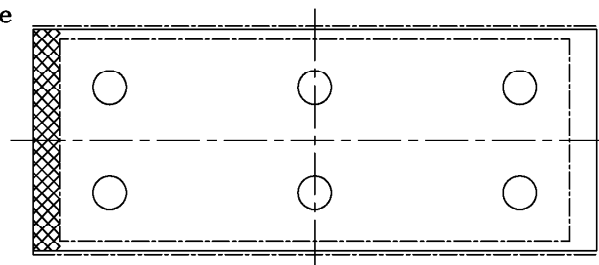

Designed by:

Checked by:

File name:

Unit:

mm

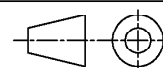

Sheet:

3 of 3