

• **SFM-2325**



FEATURES:

- This Item Is Designed For Surface Mounting Applications.
- The Pin Is Plated With Gold, Which Can Meet The Request of Re-flow Soldering Process at 260°C For 30 Seconds.
- Small Size.

DIMENSIONS: (Unit: mm)

SFM-TERMINAL VERSION

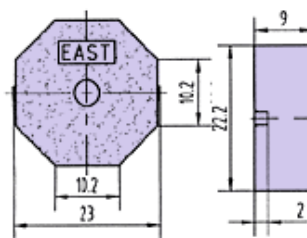

RECOMMENDED SMD FOOT PATTERN

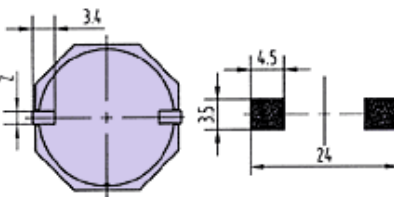

CHARACTERISTICS:

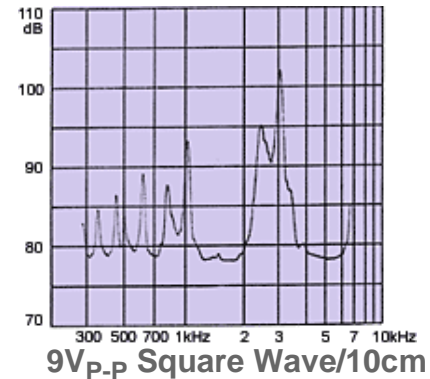

ELECTRICAL SPECIFICATIONS :

Model No.	SFM-2325
Min. Sound Pressure Level (dB)	88 /2.5kHz/9Vp-p Square Wave/10cm
Capacitance at 1000Hz (nF)	20 ± 30%
Allowable Input Voltage (V _{P-P})	40
Max. Consumption (mA)	12 /2.5kHz/9Vp-p Square Wave
Resonant Frequency (kHz)	2.5 ± 0.5
Operating Temperature (°C)	-20 ~ +70
Weight (g)	3.5
Case Material /Color	PPS /Black

PACKING INFORMATION:

TAPE TYPE INFORMATION:

The design for such tape packing was executed under standard IEC -286-3

The material of the tape is polystyrene in black color. detailed dimensions are as below :

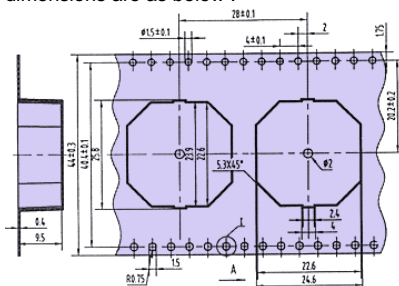

DIMENSIONS OF THE ROLLING PLATE:

The material of the rolling plate is in paper;
The dimensions of the rolling plate are as below:

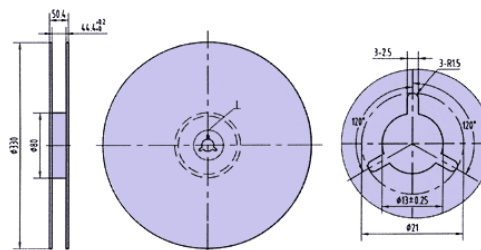

PACKING DIMENSIONS AND QUANTITY:

- The rolling plate is put into a 340X335X35mm inner packing box and is packed with 250 pcs of the transducer per plate.
- The dimension of the outer carton is 400X350X350mm containing 10 inner boxes with a total quantity of 1,500 pcs of the transducer.
- The total gross weight per carton is 10.0Kgs, while net weight is 5.3Kgs.